



# GS - GM

## B - MOLDED RUBBER

**Load capacity up to 450kg**

**RIG** Reinforced rig, made of stamped steel plate and swivel head with double ball raceway, zinc-plated finish. Bolted wheel axle.



### WHEEL

B - Molded Rubber. Hardness: 80 Shore A. (-20°C to +70°C)  
Produced with molded vulcanized rubber tread over a grey cast iron wheel center. They roll softly with a low noise level, absorb shocks and vibrations. They are resistant to abrasion and chemicals. They can be used at a speed of up to 4km/h when mounted with ball bearings.



Swivel Caster	Rigid Caster	Swivel Caster	Rigid Caster	Wheel	(mm)	(mm)	(pol)	Axle Type (bearing)	KG	(mm)	w/o brake (mm)	w/ brake FP (mm)	w/ brake GB (mm)
Reference	Reference	Reference	Reference	Reference									
GS 42 BN	FS 42 BN	GM 42 BN	FM 42 BN	R 42 BN	100	50	1/2"	Nylon Socket	200	138	87	150	-
GS 42 BR	FS 42 BR	GM 42 BR	FM 42 BR	R 42 BR				Roller Bearing					
GS 42 BE	FS 42 BE	GM 42 BE	FM 42 BE	R 42 BE	125	50	1/2"	Ball Bearing	250	165	100	167	180
GS 52 BN	FS 52 BN	GM 52 BN	FM 52 BN	R 52 BN				Nylon Socket					
GS 52 BR	FS 52 BR	GM 52 BR	FM 52 BR	R 52 BR	150	50	1/2"	Roller Bearing	300	196	121	183	185
GS 52 BE	FS 52 BE	GM 52 BE	FM 52 BE	R 52 BE				Ball Bearing					
GS 62 BN	FS 62 BN	GM 62 BN	FM 62 BN	R 62 BN	175	50	1/2"	Nylon Socket	325	222	140	197	-
GS 62 BR	FS 62 BR	GM 62 BR	FM 62 BR	R 62 BR				Roller Bearing					
GS 62 BE	FS 62 BE	GM 62 BE	FM 62 BE	R 62 BE	200	50	1/2"	Ball Bearing	350	235	153	210	-
GS 72 BN	FS 72 BN	GM 72 BN	FM 72 BN	R 72 BN				Nylon Socket					
GS 72 BR	FS 72 BR	GM 72 BR	FM 72 BR	R 72 BR	225	50	1/2"	Roller Bearing	400	280	180	222	-
GS 72 BE	FS 72 BE	GM 72 BE	FM 72 BE	R 72 BE				Ball Bearing					
GS 82 BN	FS 82 BN	GM 82 BN	FM 82 BN	R 82 BN	250	50	1/2"	Nylon Socket	450	292	193	235	-
GS 82 BR	FS 82 BR	GM 82 BR	FM 82 BR	R 82 BR				Roller Bearing					
GS 82 BE	FS 82 BE	GM 82 BE	FM 82 BE	R 82 BE	250	50	1/2"	Ball Bearing	450	292	193	235	-
GS 92 BN	FS 92 BN	GM 92 BN	FM 92 BN	R 92 BN				Nylon Socket					
GS 92 BR	FS 92 BR	GM 92 BR	FM 92 BR	R 92 BR	250	50	1/2"	Roller Bearing	450	292	193	235	-
GS 92 BE	FS 92 BE	GM 92 BE	FM 92 BE	R 92 BE				Ball Bearing					
GS 102 BN	FS 102 BN	GM 102 BN	FM 102 BN	R 102 BN	250	50	1/2"	Nylon Socket	450	292	193	235	-
GS 102 BR	FS 102 BR	GM 102 BR	FM 102 BR	R 102 BR				Roller Bearing					
GS 102 BE	FS 102 BE	GM 102 BE	FM 102 BE	R 102 BE	250	50	1/2"	Ball Bearing	450	292	193	235	-

### Fittings/Accessories



Axle hole  
13mm

Reference

SES



Threaded Stem  
1/2"NC X 32mm

Reference

SE



Threaded Stem  
1/2"NC X 64mm

Reference

SEX



Long stem

Reference

See table below

### Swivel Sections

### Top Plate Options

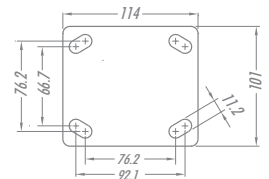
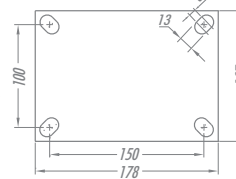
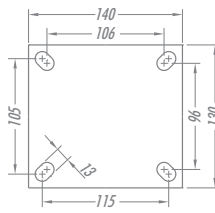
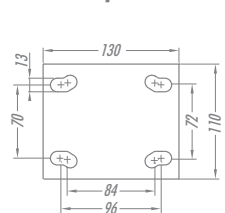
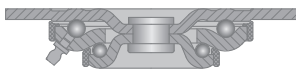

### Brake Options



GB\* - Pedal Brake



FP - Pedal Brake



FL - Side Brake

### LONG STEM FITTING

CODE	Ø	HEIGHT
ME 1	1"	150mm
ME 2	1.1/4"	
ME 3	1.5/16"	

\*Available only for 52 and 62