

MX - Axial Medium

C - CELERON

Load capacity up to 800kg

RIG









Made of steel with a painted finish and swivel section with two axial ball bearings. Bolted wheel axle



WHEEL

C - Celeron Hardness: 103 Rockwell M. (-30°C to + 120°C)

Manufactured with a compound obtained from macerated cotton fibers drenched with phenolic resin, molded by heat and pressure. They have excellent mechanical properties, are light and rugged, resistant to deformation under static loads and roll easily. They can be used over a wide temperature range. They are resistant to mild oils, greases and acids in low concentrations. Not recommended for applications in wet environments in contact with alkaline substances. (e.g., caustic soda, chlorine, cleaning products, soap and detergent). Nominal working speed is up to 4km/h.

Swivel Caster	Rigid Caster	Wheel				Axle Type (bearing)							
Reference	Reference	Reference	(mm)	(mm)	(pol)		KG	(mm)	w/o brake (mm)	w/ brake FP (mm)	w/ brake GB (mm)		
GMX 52 CR	FMX 52 CR	R 52 CR	100	50	1/2"	Ball Bearing	500	183	107	155	183		
GMX 52 CE	FMX 52 CE	R 52 CE				Plain Bearing							
GMX 62 CR	FMX 62 CR	R 62 CR	150			Roller Bearing	600	205	123	170	200		
GMX 62 CE	FMX 62 CE	R 62 CE				Ball Bearing							
GMX 82 CR	FMX 82 CR	R 82 CR	200			Plain Bearing	800	251	158	193	-		
GMX 82 CE	FMX 82 CE	R 82 CE				Roller Bearing							

Accessories



FL - Side Brake

FLD - Side Brake Duplo

GB - Pedal Brake
*Available only for 52 and 62

FP - Pedal Brake

AH - Central Brake
Consult the swivel height for this type of brake

BG - Swivel Lock

GC - Caster Guard

Swivel Sections

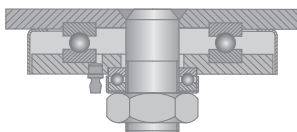

Top Plate Options

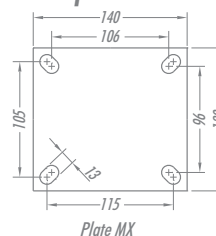

Plate MX

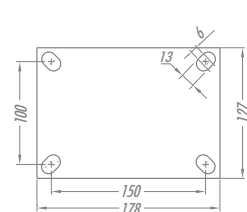

Plate MXO