

MX - Axial Medium

ME - MOLDED POLYURETHANE

Load capacity up to 700kg









RIG Made of steel with a painted finish and swivel section with two axial ball bearings. Bolted wheel axle



WHEEL

ME - Double tread Molded Polyurethane - Round. Hardness: side 60 Shore D and center 90 Shore A. (-40°C a +80°C)
Produced with a double tread molded polyurethane, with green colored high hardness cheeks and softer orange colored polyurethane center, over a grey cast iron wheel center. Round tread profile offers a reduced floor contact area, easiness for handling and maneuvering, reducing handling effort and low rolling noise level. They offer a superior service life due to its polyurethane layer larger than conventional wheels. They have an excellent resistance to abrasion, impacts, weathering and chemicals such as greases, oils, salts and solvents. Higher hardness wheel side faces allow for a higher resistance to impacts and a softer center a higher floor friction with a lower handling noise level. They may be employed in a speed up to 10km/h on floors that are not contaminated with grease or slippery liquids.



Swivel Caster	Rigid Caster	Wheel				Axle Type (bearing)					
Reference	Reference	Reference	(mm)	(mm)	(pol)		KG	(mm)	w/o brake (mm)	w/ brake FP (mm)	w/ brake GB (mm)
GMX 42 ME	FMX 42 ME	R 42 ME	100	50	1/2"	Ball Bearing	400	155	84	143	-
GMX 52 ME	FMX 52 ME	R 52 ME	125			Roller Bearing	450	183	107	155	183
GMX 62 ME	FMX 62 ME	R 62 ME	150			Ball Bearing	550	205	123	170	200
GMX 82 ME	FMX 82 ME	R 82 ME	200			Ball Bearing	650	251	158	193	-
GMX 102 ME	FMX 102 ME	R 102 ME	250			Ball Bearing	700	306	197	225	-

Accessories



FL - Side Brake

FLD - Side Brake Duplo

GB - Pedal Brake
*Available only for 52 and 62

FP - Pedal Brake

AH - Central Brake
Consult the swivel height for this type of brake

BG - Swivel Lock

GC - Caster Guard

Swivel Sections

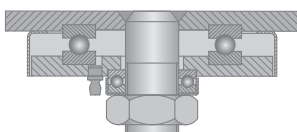

Top Plate Options

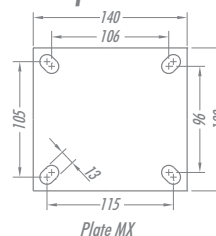

Plate MX

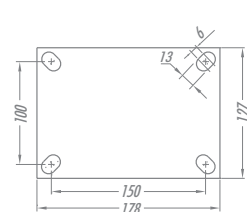

Plate MXO