



# YPEX

## F - CAST IRON







Load capacity up to 3800kg

**RIG** Reinforced rig, made of carbon steel, swivel section with axial ball bearing and taper roller bearings. Painted finishing Bolted wheel axle.



**WHEEL**

F - Cast Iron. Hardness: 160 Brinell. (-40°C to + 400°C)  
Produced with grey cast iron, they roll easily offering a great handling effort reduction. They are very resistant withstanding high loads and temperatures. They are not indicated to utilization when noise level and floor maintenance are required.

Swivel Caster	Rigid Caster	Wheel	 (mm)	 (mm)	 (pol)	Axle Type (bearing)	 KG	 (mm)	 (mm)
Reference	Reference	Reference							
YGPEX 63 FE	YFPEX 63 FE	R 63 FE	150	151	25	Ball Bearing	2000	240	135
YGPEX 83 FE	YFPEX 83 FE	R 83 FE	200				2400	290	170
YGPEX 103 FE	YFPEX 103 FE	R 103 FE	250				2600	348	210
YGPEX 123 FE	YFPEX 123 FE	R 123 FE	300				2800	398	255
YGPEX 64 FE	YFPEX 64 FE	R 64 FE	150	213	30		2400	245	140
YGPEX 84 FE	YFPEX 84 FE	R 84 FE	200				2800	300	180
YGPEX 104 FE	YFPEX 104 FE	R 104 FE	250				3600	365	230
YGPEX 124 FE	YFPEX 124 FE	R 124 FE	300				3800	390	255

### Accessories/Brake Options



FL - Side Brake



BG - Swivel Lock

### Swivel Sections

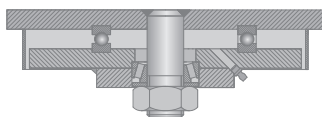

### Top Plate Options

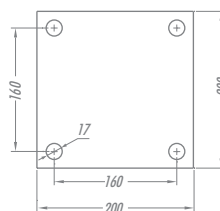

Plate 63 a 123

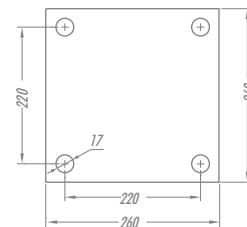

Plate 64 a 124